

Digital Dual-channel Diversity Microphone System



[User Manual]

Preface

Thank you for the purchase of Digital Dual-channel Diversity Microphone System. This manual will give comprehensive instructions and operation. Please read it over before your use to perform this unit well.

Contents

Illustration 1

Setup Procedure 2

Digital Wireless Receiver Module 3 ~ 4

Digital Handheld Microphone 5 ~ 7

Digital Pendant/Bodypack Transmitter 8 ~ 10

Important Notes / Troubleshooting 11

Specifications 12 ~ 13

This device complies with part 15 of the FCC Rules.

Operation is subject to the following two conditions: (1) This device may not cause harmful interference, and (2) this device must accept any interference received, including interference that may cause undesired operation.

Notice: The changes or modifications not expressly approved by the party responsible for compliance could void the user's authority to operate the equipment.

FCC INFORMATION

The Federal Communication Commission Radio Frequency Interference Statement includes the following paragraph:

The equipment has been tested and found to comply with the limits for a Class B Digital Device, pursuant to part 15 of the FCC Rules.

These limits are designed to provide reasonable protection against harmful interference in a residential installation.

This equipment generates, uses and can radiate radio frequency energy and, if not installed and used in accordance with the instruction, may cause harmful interference to radio communication.

However, there is no grantee that interference will not occur in a particular installation. If this equipment dose cause harmful interference to radio or television reception, which can be determined by turning the equipment off and on, the user is encouraged to try to correct the interference by one or more of the following measures:

- Reorient or relocate the receiving antenna.
- Increase the separation between the equipment and receiver.
- Connect the equipment into an outlet on a circuit different from that to which the receiver is connected.
- Consult the dealer or an experienced radio/TV technician for help.

IMPORTANT NOTE: To comply with the FCC RF exposure compliance requirements, no change to the antenna or the device is permitted. Any change to the antenna or the device could result in the device exceeding the RF exposure requirements and void user's authority to operate the device.

Illustration

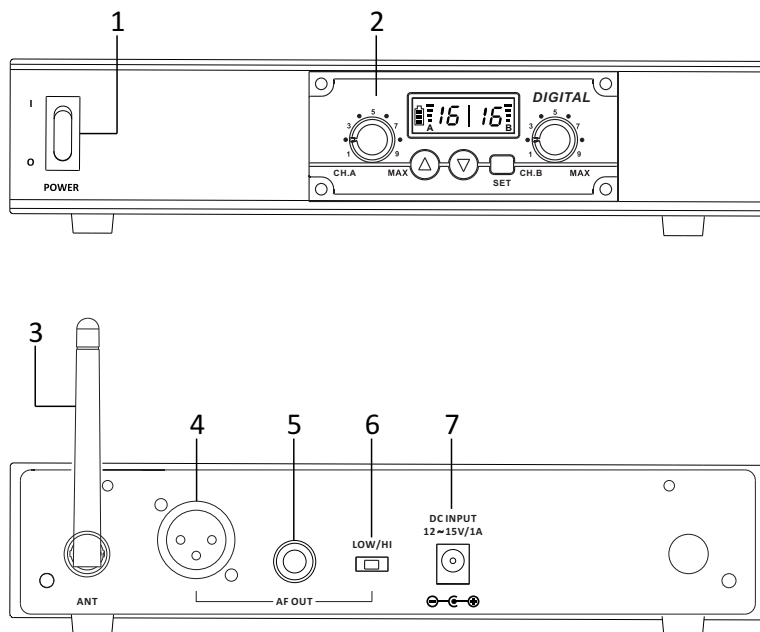

1. Power Switch
2. Digital Wireless Receiver Module
3. Antennas
4. Balanced AF XLR Output
5. Unbalanced AF Output (6.3 mm jack)
6. AF Impedance Selection (for 5)
7. DC Power Socket

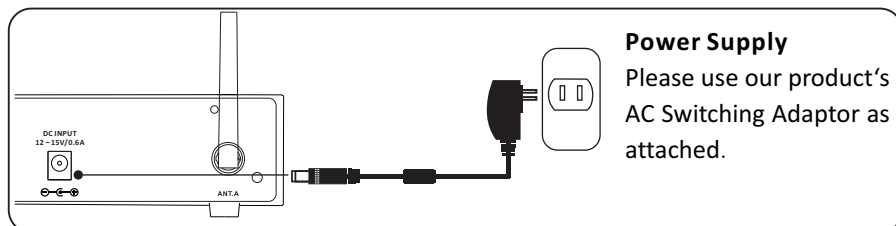

Digital Wireless Receiver Module

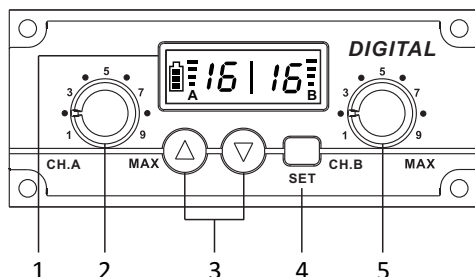

1. LCD display
(channel number/
signal strength/
A channel battery meter)
2. A channel volume
3. Channel selection
4. Set key
5. B channel volume

■ Operation

Power on and Off

1. Receiver module powers on along with the PA, LCD displays On, and after 1 to 2 seconds, screen displays channel number.
2. Receiver module powers off along with the PA, LCD displays Off, after 2 to 3 seconds the display shuts off.

Channel changing

1. Hold on SET key to enter channel changing mode, once the channel number on the display starts to flash, you may use the up and down key to select channel.
2. After confirm the channel, press SET key again, or it also auto confirms without pressing any keys for less than 10 seconds.

Operating range Hi/Low setting

1. In off mode, press SET key and power on the PA to enter the setting mode.
2. Now the screen flashes Hi or Lo, press up and down key to switch in between.
3. Press SET key again to confirm, or it also auto confirms without pressing any keys for less than 5 seconds.

Setting channel synchronization

- a. When both microphones are set as Master:
 - 1. First powered on microphone will be set as channel A, and the second is channel B.
 - 2. When channel A microphone is shut off or out of signal for more than 5 seconds, B channel microphone auto switches to channel A.
 - 3. Both channels A and B need to be within the range of 15 meters when power on.
- b. When the microphones are assigned as Master and Slave:
 - 1. Preset Master microphone will be identifying as channel A, and the slave will be channel B.
 - 2. When channel A microphone is shut off or out of signal for more than 5 seconds, B channel microphone auto shuts off.
 - 3. Only when microphone is set to slave and push to talk mode, the synchronization is at full range. The other modes are set within 15 meters.

Digital Handheld Microphone

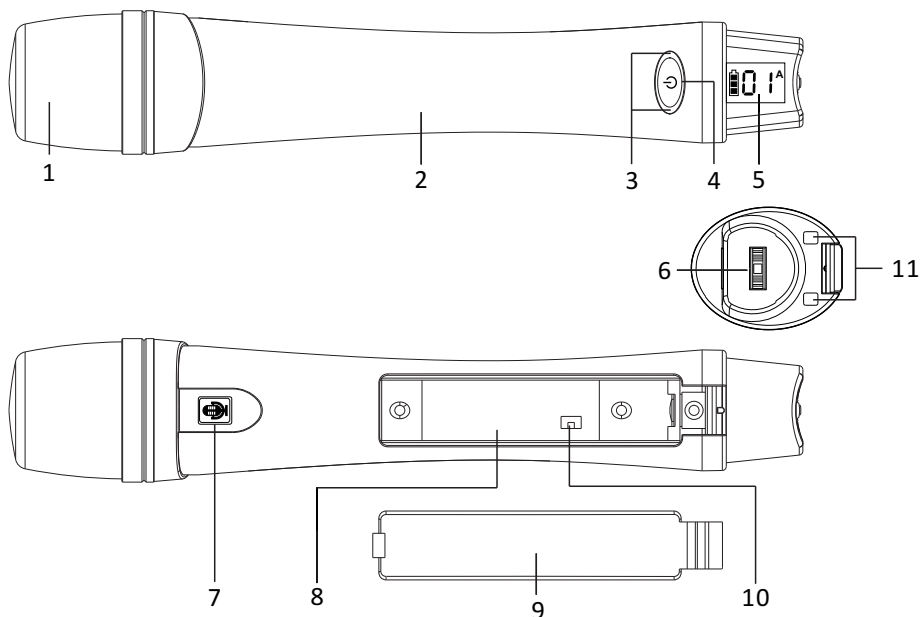

- | | |
|--------------------|-----------------------------|
| 1. Mesh head | 7. Talk/Mute button |
| 2. Handheld tube | 8. Battery holder |
| 3. Power indicator | 9. Battery door |
| 4. Power button | 10. Maser/Slave mode switch |
| 5. LCD display | 11. Charging contacts |

(Press to set, scroll up and down to adjust)

Insert battery



Open battery door and insert 2 AA 1.2 V (Ni-MH 1600mAh) or 2 AA 1.5 V Alkaline batteries. Make sure the batteries are allocated in correct direction.



Digital Handheld Microphone

■ Handheld method

Do not block bottom signal source.



■ Operation and Setup

Power On

Insert battery and press power button to turn on, power indicator (3) lights on. Blue light means battery power is efficient and red means insufficient.

Volume adjustment

Press setup wheel (6) then scroll up and down to adjust volume.

Master/Slave mode setup

After battery is taken off, you can see master/slave mode switch(10).

- When set to Master mode, the default channel will be A CH, when A CH is occupied, the channel will switch to B CH
- When set to Slave mode, the default channel will be B CH, and it will always stay in B CH.

Under "Talk" mode:

Green microphone icon - Talk; Red microphone icon - Mute

Under "Push" mode:

Green microphone icon - Talk; Flashing red microphone icon - Mute

Push Talk mode

1. Press mute (7) to talk.
2. Let go mute (7) to mute.
3. It does not support more than 3 microphones.

Digital Handheld Microphone

Channel synchronization

- The microphone will automatically sync when powered on.
- When syncing successfully, mute key lights in blue and channel number shows. If syncing failed, then mute key lights in red and no channel number display.
- When microphone is set to slave mode:
 1. B CH only functions when A CH exists.
 2. When A CH is in use, you will not be able to talk.
 3. When A CH gets shut down, B CH also automatically shuts down.
- Requires within 15 meters.
- If idle more than 30mins, then microphones shuts off.

Power Off

Hold on to power key (4) for more than 2 seconds to shut off.

Charging

You may charge the microphone with rechargeable batteries by charger(purchase separately).

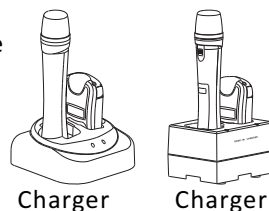

CAUTION!!

- ※ ***DO NOT attempt to charge Alkaline battery. It will lead to battery leakage or even explosion!***
- ※ ***Take out batteries when the devices won't be operated in a long time.***

Digital Pendant/Bodypack Transmitter

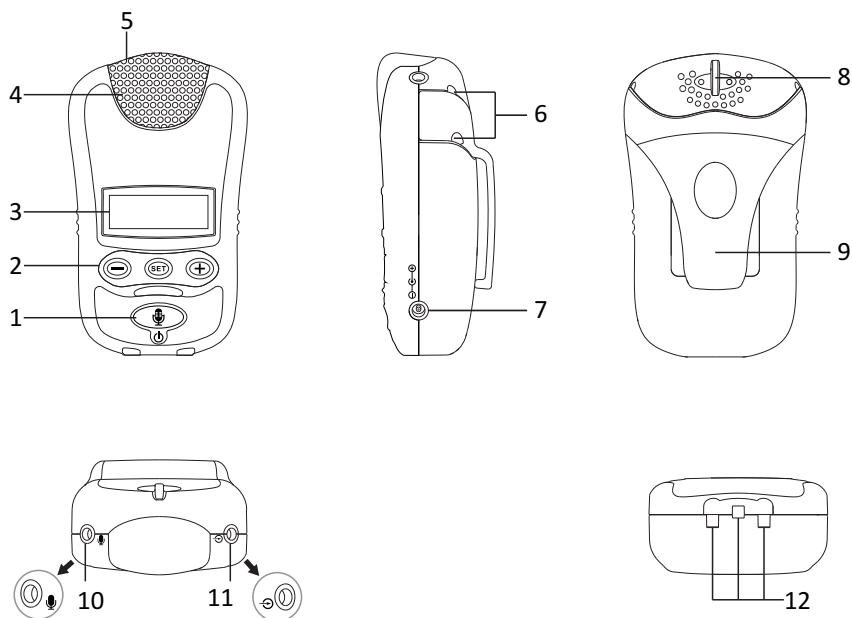

- 1. Power/Mute switch
- 2. Volume control
- 3. LCD window
- 4. Mesh Head

- 5. Charging indicator
- 6. Neck strap hole
- 7. DC input
- 8. Strap hole

- 9. Belt clip.
- 10. Mic in
- 11. AUX in
- 12. Charging terminal

■ Operation and Setup

Power ON

1. Press power key (1) to power on.
2. Once powered on, the channel selection blinks and standby for pairing. Once paired successfully, battery meter, channel number and Ch. A or Ch. B display on the screen.
3. When the device idle more than 30 minutes without paring, the device shuts off.

Digital Pendant/Bodypack Transmitter

Power OFF

1. Press and hold for two seconds to turn the device off.
2. OFF display on screen and all indicators turned off.

Mute / Talk switch

1. Press Mute switch (1) to switch between mute and talk mode.
2. Talk mode lights in blue and mute mode lights in red.

Channel synchronization

- The pendant microphone will automatically sync when powered on.
- When syncing successfully, mute key lights in blue and channel number shows. If syncing failed, then mute key lights in red and no channel number display.
- When microphone is set to slave mode:
 1. B CH only functions when A CH exists.
 2. When A CH is in use, you will not be able to talk.
 3. When A CH gets shut down, B CH also automatically shuts down.
- Requires within 15 meters
- If idle more than 30mins, then microphones shut off.

Charging mode

1. LED lights red when charging.
2. LED lights green when battery is fully charged.
3. When device is slot into a charger stand, will off the power.
4. Battery error: LED status lights red and flashes when charging, LCD battery symbol lights flashes, and it caused by:
 - (1)The battery charge temperature is exceeded 60 °C.
 - (2)The duration of charging time for charger stand is exceeded seven hours.
 - (3)The battery is defected.

Master/Slave mode

1. When the device is turned off, press SET key (2) then power key (1) to enter set up mode.
2. When the screen blinks with “Master” or “Slave”, press ⊕ or ⊖ (2) to switch mode.
3. Press SET (2) to confirm and exit or it auto confirms within 5 seconds.

Digital Pendant/Bodypack Transmitter

Volume switch

- LCD screen will display current used volume level when press ⊕ or ⊖ (VOL. 1 ~ 3).

Reset

- Press ⊕ and ⊖ (2) then press power key (1) to power on to enter RESET mode.
The default value is Volume 2, and Master/Slave does not affect by RESET mode.

Method to install neck strap

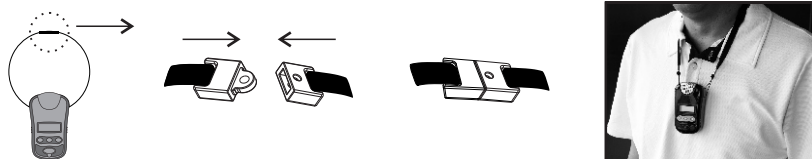

- ※ The best distance is 10 CM between pendant microphone and user's chin.

CAUTION!!

- ※ *To maintain battery life, please charge fully after use every time, or every 3 months.*
- ※ *If battery require replacement, please pass to professional technician to do so.*

Important Notes

Avoiding heat and humidity

- Keep the device away from any heat source and in a location with good ventilation. Do not leave it under sunlight or close to heater.
- DON'T operate the device in the rain or in humid circumstance to prevent failure.
- Prevent the device from dropping.
- Apply factory recommended power supply to this system only. It is dangerous and risky when employing a unqualified power.

Replacing batteries

- Make sure the substitute batteries are with same specifications.
- Using incorrect batteries might lead to explosion or malfunction.

Remove battery from transmitter when you won't use it for a long while.

Charging contacts

- Clean charging contacts regularly to ensure good connection with charger. When any corrosion occurs, contact your dealer to change it if you can't repair it.

Troubleshooting

Failed to Power On

- Be sure batteries are allocated and put in correct direction.
- Be sure power adapter is plugged well.

No Sound Output

- Be sure volume control on transmitter and receiver are turned properly.
- Be sure Mute button is not on.
- Be sure transmitter and receiver stay at same channel.
- Check if there is huge air interference nearby.

Acoustic feedback is overlarge

- Adjust the volume of microphone and receiver module properly.

Failing to charge

- Make sure the charger is connected with power supply correctly.
- Make sure battery contacts are clean and free of corrosion.
- Change batteries if the device still can't be charged.

Specifications

Digital Dual-channel Receiver

Receiver Module	Digital wireless receiver module
LCD window	Channel, Frequency
Channel adjustment	Set up key, up and down key
Carrier frequency	2.4 - 2.5 GHz
Channels	16
Output level	XLR : 1 V / 600 Ω
	Φ 6.3 mm : 700 mV / 2k Ω (Hi)
	Φ 6.3 mm : 70 mV / 2k Ω (Low)
Audio output	Φ 6.3 mm MIC-out (mixer), XLR-balanced
Ambient temperature	-10° C ~ +50° C
Power supply	AC switching power adapter 100 ~ 240 V, 12 ~ 15 V / 0.6 A
Frequency modulation	75 MHz (max.)
T.H.D.	< 1 %
Pre-emphasis	50 μ s
Frequency response	70 Hz ~ 18 kHz
Wireless coverage	\leq 30 M
Dimensions (DxWxH)	215 x 215 x 50 mm
Weight	1.1 kg

※ Specifications are subject to change

Specifications

Digital Pendant/Bodypack Transmitter

Microphone capsule	condenser
Antenna	internal
RF output power	Max 10 dBm
Audio input	Mic in, Aux in
Mic in jack	3.5 mm
Audio control	Mute, Hi/Mid/Low sensitivity
Battery	Lithium (1200 mAh)
Running time	24 hours
Dimensions (DxWxH)	32 x 52 x 88 mm
Weight	77 g (battery included)

Digital Handheld Microphone

Microphone capsule	condenser
Antenna	internal
RF output power	Max 10 dBm
Audio control	Talk / Mute button
Battery	2 AA 1.2 V (Ni-MH, 1600 mAh); or 2 AA 1.5 V (Alkaline)
Running time	17 ~ 18 (Ni-MH) / 15 ~ 20 (Alkaline) hours, typical
Dimensions (ΦxL)	37 (dia.) x 200 mm
Weight	91 g (battery included)

