



Digital

Wireless Portable Sound System



GPA-580 Series

DIGITAL WIRELESS PORTABLE SOUND SYSTEM

[User Manual]

Preface

Thank you for the purchase of Digital Wireless Portable Sound System, GPA-580. This manual provides comprehensive instructions and operations. Please read it over before your operation on the unit.

All peripheral and accessories are subject to order. Components in the package might be different by demand.

Contents

Product mix.....	1
Illustration	2
Controls and Operation	3
Digital Wireless Receiver Module DR-600.....	4-5
Digital Audio Player UM-502.....	6-7
Bluetooth Receiver Module BX-501.....	8
Digital Handheld Microphone EJ-601TM.....	9-11
Digital Pendant/Bodypack Transmitter EJ-6T.....	12-14
Troubleshooting	15
Maintenance.....	16-17
Specifications	18-19
Memo.....	20-21

Product Mix

GPA-580D1

Wireless Portable Sound Systems,
1 receiver built-in

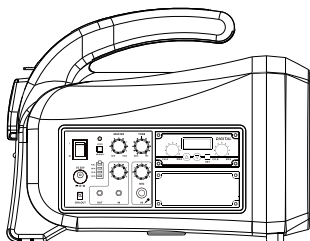

GPA-580D2

Wireless Portable Sound Systems,
2 receivers built-in

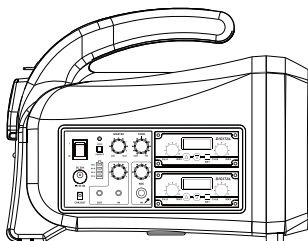

GPA-580DU

Wireless Portable Sound Systems,
1 receiver and 1 audio player built-in

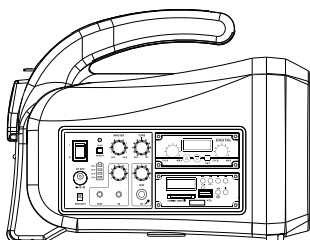

GPA-580U

Portable Powered Speaker,
1 audio player built-in

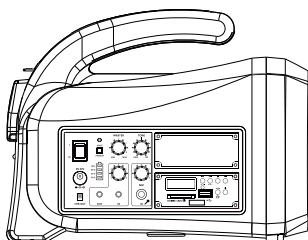

GPA-580DX1

Wireless Portable Sound Systems,
1 receiver and 1 bluetooth module built-in

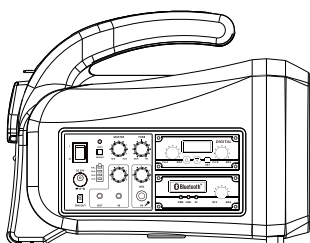

Illustration

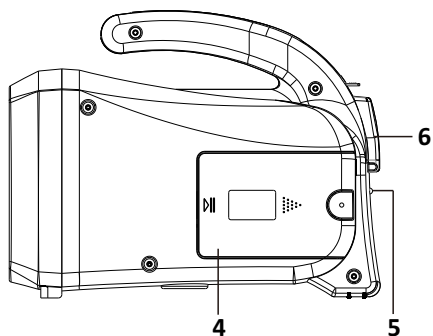
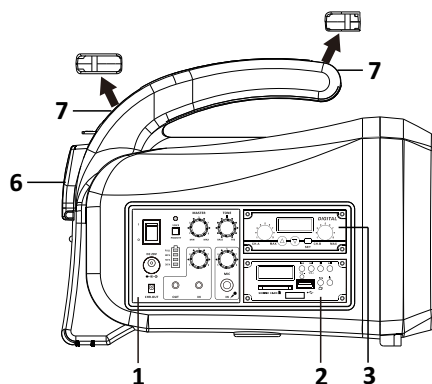

1. Controls, battery meter, mic in
2. Receiver DR-600
3. Digital audio player UM-502
4. Battery door

5. LED indicator (EJ-601TM)
6. Drop in charger (EJ-601TM)
7. Strap buckle

Battery replacement



Get screws off



Take battery out



Get connection right –
RED for Anode;
BLACK for Cathode

Controls and Operation

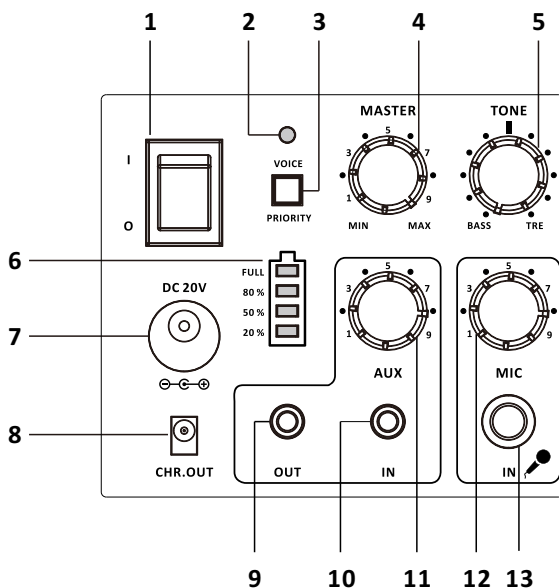

1. Power switch
2. Voice priority indicator
3. Voice priority: when it is activated, an indicator (2) will light up.
4. Master
5. Tone
6. Battery meter
7. DC IN
8. 5V charger (for EJ-5T)
9. Aux out, Ø 3.5mm
10. Aux in, Ø 3.5 mm
11. Aux in control
12. Mic (wired) in control
13. Wired mic input

Digital Wireless Receiver Module DR-600

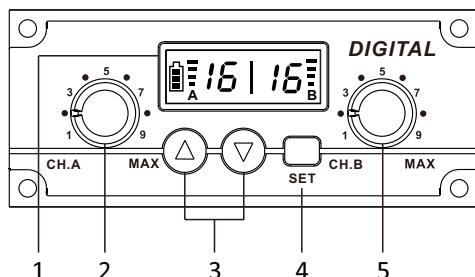

1. LCD display
(channel number/
signal strength/
A channel battery meter)
2. A channel volume
3. Channel selection
4. Set key
5. B channel volume

Operation

Power on and Off

1. Receiver module powers on along with the PA, LCD displays On, and after 1 to 2 seconds, screen displays channel number.
2. Receiver module powers off along with the PA, LCD displays Off, after 2 to 3 seconds the display shuts off.

Channel changing

1. Hold on SET key to enter channel changing mode, once the channel number on the display starts to flash, you may use the up and down key to select channel.
2. After confirm the channel, press SET key again, or it also auto confirms without pressing any keys for less than 10 seconds.

Operating range Hi/Low setting

1. In off mode, press SET key and power on the PA to enter the setting mode.
2. Now the screen flashes Hi or Lo, press up and down key to switch in between.
3. Press SET key again to confirm, or it also auto confirms without pressing any keys for less than 5 seconds.

Setting channel synchronization

- a. When both microphones are set as Master:
 - 1. First powered on microphone will be set as channel A, and the second is channel B.
 - 2. When channel A microphone is shut off or out of signal for more than 5 seconds, B channel microphone auto switches to channel A.
 - 3. Both channels A and B need to be within the range of 15 meters when power on.
- b. When the microphones are assigned as Master and Slave:
 - 1. Preset Master microphone will be identifying as channel A, and the slave will be channel B.
 - 2. When channel A microphone is shut off or out of signal for more than 5 seconds, B channel microphone auto shuts off.
 - 3. Only when microphone is set to slave and push to talk mode, the synchronization is at full range. The other modes are set within 15 meters.

Digital Audio Player UM-502

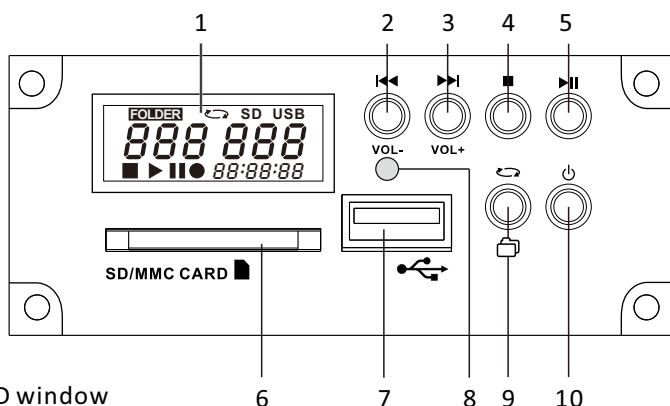

1. LCD window
2. Previous track / volume down
(works during playback)
3. Next track / volume up
(works during playback)
4. Stop
5. Play / Pause
6. SD/MMC port
7. USB port
8. Sensor
9. Repeat / Folder select
10. Power
11. Volume down (MUTE when in minimum level)
13. Volume up
13. Mute
14. Folder select

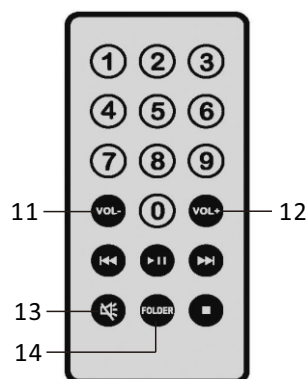



Operation

1. Press and hold (10) for 1 second to turn this player on. Press and hold (10) for 1 second to turn it off.
2. Press (2) to play previous audio track; press (3) to play next audio track. Press (4) to stop any playback.
3. Press (5) to Play or to Pause any audio track.
4. When both SD card and USB are installed, USB has higher priority to be readout.
5. Do not pull SD card out directly or it might be damaged. Just push it a bit forward and it will be ejected.

6. Repeat / Folder Select:

a. There are 3 modes for repeat during audio playback.

-  : To repeat a track.
-  : To repeat all tracks in all album.
-  : To repeat all tracks in a single album.

b. When not in playback, press (9) to select a desired folder/album with NEXT, PREV buttons. Finally press PLAY to end the setting.

7. During playback, press VOL+ to increase volume; press VOL- to decrease volume.

Bluetooth Receiver Module BX-501

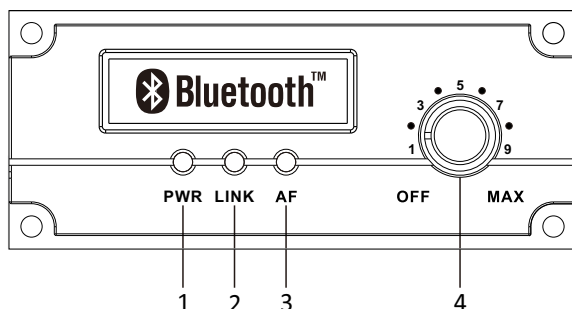

■ Illustration

1. Power indicator
2. Bluetooth connectivity indicator
3. Audio frequency indicator
4. On/Off/Volume switch

■ Operation

1. Switch it on clockwise to activate Bluetooth function.
2. A prompt tone will come out and the PWR indicator will light blue. LINK indicator will flash blue as a sign of pairing in action.
3. When in pairing mode, activate Bluetooth connection on your smartphone or any target device you want to do so. Find a device name of "okayo GPA" on pairing list and get your smartphone connected.
4. When the pairing is done successfully, it will come out with a prompt tone again. The button will light steady blue.
5. You are ready to stream the audio via Bluetooth from your smartphone. You can adjust the audio volume on smartphone or through the volume switch of Bluetooth receiver.
6. AF indicator will light green when audio signal is received by Bluetooth receiver.
7. During Bluetooth connection, it will stop audio playback when a call is made to your smartphone. When the call is finished, Bluetooth will be relinked automatically and audio files will be played.
8. When Bluetooth connection is out of range between this Portable PA and smartphone, it could be relinked automatically if users get back to service range shortly. However, it depends on applied OS platform of the smartphone. In some cases, you get to manually connect Bluetooth again.

Digital Handheld Microphone EJ-601TM

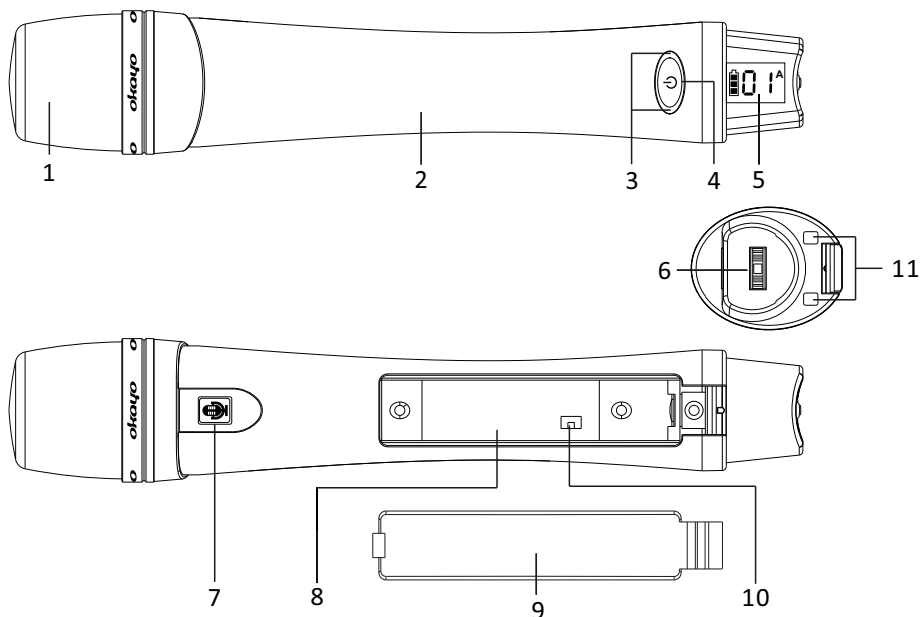

- 1. Mesh head
- 2. Handheld tube
- 3. Power indicator
- 4. Power button
- 5. LCD display
- 6. setup wheel
- 7. Talk/Mute button
- 8. Battery holder
- 9. Battery door
- 10. Maser/Slave mode switch
- 11. Charging contacts

(Press to set, scroll up and down to adjust)

Insert battery



Open battery door and insert 2 AA 1.2 V (Ni-MH 1600mAh) or 2 AA 1.5 V Alkaline batteries. Make sure the batteries are allocated in correct direction.



Digital Handheld Microphone EJ-601TM

■ Handheld method

Do not block bottom signal source.



■ Operation and Setup

Power On

Insert battery and press power button to turn on, power indicator (3) lights on. Blue light means battery power is efficient and red means insufficient.

Volume adjustment

Press setup wheel (6) then scroll up and down to adjust volume.

Master/Slave mode setup

After battery is taken off, you can see master/slave mode switch(10).

- When set to Master mode, the default channel will be A CH, when A CH is occupied, the channel will switch to B CH
- When set to Slave mode, the default channel will be B CH, and it will always stay in B CH.

Under "Talk" mode:

Green microphone icon - Talk; Red microphone icon - Mute

Under "Push" mode:

Green microphone icon - Talk; Flashing red microphone icon - Mute

Push Talk mode

1. Press mute (7) to talk.
2. Let go mute (7) to mute.
3. It does not support more than 3 microphones.

Digital Handheld Microphone EJ-601TM

Channel synchronization

- The microphone will automatically sync when powered on.
- When syncing successfully, mute key lights in blue and channel number shows. If syncing failed, then mute key lights in red and no channel number display.
- When microphone is set to slave mode:
 1. B CH only functions when A CH exists.
 2. When A CH is in use, you will not be able to talk.
 3. When A CH gets shut down, B CH also automatically shuts down.
- Requires within 15 meters.
- If idle more than 30mins, then microphones shuts off.

Power Off

Hold on to power key (4) for more than 2 seconds to shut off.

Charging

You may charge the microphone with rechargeable batteries by HDC-502/503(purchase separately).

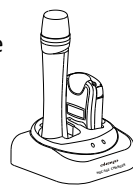

HDC-502



HDC-503

CAUTION!!

- ※ ***DO NOT attempt to charge Alkaline battery. It will lead to battery leakage or even explosion!***
- ※ ***Take out batteries when the devices won't be operated in a long time.***

Digital Pendant/Bodypack Transmitter EJ-6T

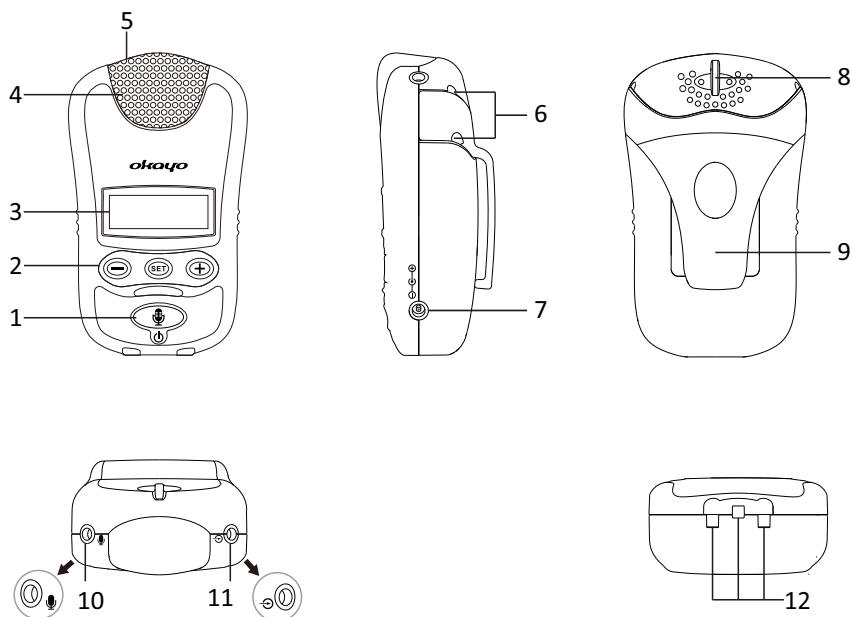

- 1. Power/Mute switch
- 2. Volume control
- 3. LCD window
- 4. Mesh Head

- 5. Charging indicator
- 6. Neck strap hole
- 7. DC input
- 8. Strap hole

- 9. Belt clip.
- 10. Mic in
- 11. AUX in
- 12. Charging terminal

■ Operation and Setup

Power ON

1. Press power key (1) to power on.
2. Once powered on, the channel selection blinks and standby for pairing. Once paired successfully, battery meter, channel number and Ch. A or Ch. B display on the screen.
3. When the device idle more than 30 minutes without paring, the device shuts off.

Power OFF

1. Press and hold for two seconds to turn the device off.
2. OFF display on screen and all indicators turned off.

Mute / Talk switch

1. Press Mute switch (1) to switch between mute and talk mode.
2. Talk mode lights in blue and mute mode lights in red.

Channel synchronization

- The pendant microphone will automatically sync when powered on.
- When syncing successfully, mute key lights in blue and channel number shows. If syncing failed, then mute key lights in red and no channel number display.
- When microphone is set to slave mode:
 1. B CH only functions when A CH exists.
 2. When A CH is in use, you will not be able to talk.
 3. When A CH gets shut down, B CH also automatically shuts down.
- Requires within 15 meters
- If idle more than 30mins, then microphones shut off.

Charging mode

1. LED lights red when charging.
2. LED lights green when battery is fully charged.
3. When device is slot into a charger stand, will off the power.
4. Battery error: LED status lights red and flashes when charging, LCD battery symbol lights flashes, and it caused by:
 - (1)The battery charge temperature is exceeded 60 °C.
 - (2)The duration of charging time for charger stand is exceeded seven hours.
 - (3)The battery is defected.

Master/Slave mode

1. When the device is turned off, press SET key (2) then power key (1) to enter set up mode.
2. When the screen blinks with “Master” or “Slave”, press ⊕ or ⊖ (2) to switch mode.
3. Press SET (2) to confirm and exit or it auto confirms within 5 seconds.

Digital Pendant/Bodypack Transmitter EJ-6T

Volume switch

- LCD screen will display current used volume level when press ⊕ or ⊖ (VOL. 1 ~ 3).

Reset

- Press ⊕ and ⊖ (2) then press power key (1) to power on to enter RESET mode.
The default value is Volume 2, and Master/Slave does not affect by RESET mode.

Method to install neck strap

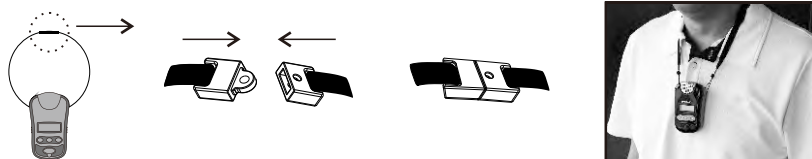

- ※ The best distance is 10 CM between pendant microphone and user's chin.

CAUTION!!

- ※ *To maintain battery life, please charge fully after use every time, or every 3 months.*
- ※ *If battery require replacement, please pass to professional technician to do so.*

Caution

- DON'T operate the device in the rain or in humid circumstance to prevent failure.
- Prevent the device from dropping.
- Apply factory recommended power supply to this system only. It is dangerous and risky when employing a not qualified power.

Troubleshooting

Failed to Power On

- Be sure batteries are allocated and put in correct direction.
- Be sure power adapter is plugged well.

No Sound Output

- Be sure transmitter and receiver stay at same channel.
- Be sure volume control on transmitter and receiver are turned properly.
- Be sure Master is turned properly.
- Be sure Mute button is not on.
- Check if transmitter and receiver stay at same frequency band.
- Check if there is huge air interference nearby.

Avoid heat, humidity

DO NOT put the unit in the sunshine for a long time, or any other hot, humid environments or places with flame. Stay away from any occasions where situation mentioned above might occur. Store the unit in general indoor temperature or in cool circumstance.

Charge BEFORE you start using for the first time

After unpacking the unit for the first time, please charge the unit for about 8 hours. This is absolutely necessary as the built-in rechargeable battery might have been discharged naturally due to long transportation and storage time, even though it has been fully charged in the factory prior to shipment. To secure a longer life for battery, please **MUST** execute this **IMPORTANT** process.

Charge fully

Ensure battery is fully charged **BEFORE** you store the unit. To remain a longer battery life and better performance, make sure you charge the battery regularly every month.

 **When you need to use the unit again after a long period of storage, make sure you charge it fully for at least 8 hours BEFORE any operation.**

 **Please also charge this unit every time right after operation to secure a longer battery life.**

This unit has DOD (depth of discharge) protection design. When Power Switch LED flashes red - which means there isn't enough electricity (when operating via the battery's power - this unit will turn off automatically in a short time to secure battery from deep-discharging damage. At this moment please immediately recharge your unit, do not continue with operation.

This unit has protection circuit against overcharge. The circuit will stop charging when battery is fully charged even power cord is plugged.

Useful hint: You can still operate during charging.

Replacing battery

Make sure the substitute battery is in compliance with qualified specifications. Using incorrect battery may lead to explosion or malfunction.

Maintenance Specifications

Remove battery from handheld microphone when you won't use it for a long while.

Charging contacts

Clean charging contacts regularly to ensure good connection with charger. When any corrosion occurs, contact your dealer to change it if you can't repair it.

This device complies with part 15 of the FCC Rules.

Operation is subject to the following two conditions: (1) This device may not cause harmful interference, and (2) this device must accept any interference received, including interference that may cause undesired operation.

Notice: The changes or modifications not expressly approved by the party responsible for compliance could void the user's authority to operate the equipment.

FCC INFORMATION

The Federal Communication Commission Radio Frequency Interference Statement includes the following paragraph:

The equipment has been tested and found to comply with the limits for a Class B Digital Device, pursuant to part 15 of the FCC Rules.

These limits are designed to provide reasonable protection against harmful interference in a residential installation.

This equipment generates, uses and can radiate radio frequency energy and, if not installed and used in accordance with the instruction, may cause harmful interference to radio communication.

However, there is no guarantee that interference will not occur in a particular installation. If this equipment does cause harmful interference to radio or television reception, which can be determined by turning the equipment off and on, the user is encouraged to try to correct the interference by one or more of the following measures:

- Reorient or relocate the receiving antenna.
- Increase the separation between the equipment and receiver.
- Connect the equipment into an outlet on a circuit different from that to which the receiver is connected.
- Consult the dealer or an experienced radio/TV technician for help.

IMPORTANT NOTE: To comply with the FCC RF exposure compliance requirements, no change to the antenna or the device is permitted. Any change to the antenna or the device could result in the device exceeding the RF exposure requirements and void user's authority to operate the device.

Digital Wireless Portable Sound System GPA-580

Output power	40 W (RMS) @ 4 Ω
Speaker	5" Neo driver
Digital audio player	supports USB disk and SD card (optional)
Receiver	plug-in receiver with ACS (Auto Channel Synchronization), supports 2 receivers maximum.
Audio input	mic in (6.3mm); aux in (stereo mixed, 3.5 mm)
Audio output	aux out (stereo mixed, 3.5 mm)
Controls	Receiver, Master, Tone, Mic, Aux in
Power supply	AC switching power adapter 100 ~ 240 V, 20 V / 3.25 A
Battery	Lithium rechargeable battery
Charging time	8 ~ 12 hours (battery dependant)
Running time	3 ~ 6 hours (battery dependant)
Battery meter	FULL, 80%, 50%, 20%
Dimensions (DxWxH)	333 x 153 x 246 mm
Weight	3.1 kg (Lithium battery included)

Digital Wireless Receiver Module DR-600

Carrier frequency	2.4 ~ 2.5 GHz
Channels	16
LCD window	channel, frequency
Channel adjustment	Set up key, up and down key
Ambient temperature	-10 °C ~ +50 °C
T.H.D.	< 1 %
Pre-emphasis	50 μ s
Frequency response	70 Hz ~ 18 kHz
Wireless coverage	< 30 meters

※ Specifications are subject to change

Specifications

Digital Audio Player UM-502

Frequency response	20 Hz ~ 20 kHz
Power requirement	DC 12 V
Display	backlit LCD
Output level	600 mV
Format supported	MPEG Layer 3
S/N ratio	> 60 dB
T.H.D.	< 1 %
Remote range	> 3 m
Controls	Play, Stop, Repeat, Next, Prev.
External audio supported	USB disk, SD card

Digital Pendant/Bodypack Transmitter EJ-6T

Microphone capsule	condenser
Antenna	internal
RF output power	Max 10 dBm
Audio input	Mic in, Aux in
Mic in jack	3.5 mm
Audio control	Mute, Hi/Mid/Low sensitivity
Battery	Lithium (1200 mAh)
Running time	24 hours
Dimensions (DxWxH)	32 x 52 x 88 mm
Weight	77 g (battery included)

Digital Handheld Microphone EJ-601TM

Microphone capsule	condenser
Antenna	internal
RF output power	Max 10 dBm
Audio control	Talk / Mute button
Battery	2 AA 1.2 V (Ni-MH, 1600 mAh); or 2 AA 1.5 V (Alkaline)
Running time	17 ~ 18 (Ni-MH) / 15 ~ 20 (Alkaline) hours, typical
Dimensions (ΦxL)	37 (dia.) x 200 mm
Weight	91 g (battery included)



OKAYO ELECTRONICS CO., LTD.

No. 2, Gongye 10th Rd., Dali Dist., Taichung 41280, Taiwan

Tel:+886-4-2491-4666 Fax:+886-4-2491-3066

E-mail: okayo@okayo.com

www.okayo.com